

5/8" BORE CORROSION RESISTANT CYLINDER



CR-SDD-10-□-□

Double Acting

Mount: Stud
Type: Double Rod

Standard Stroke Lengths: 1/2", 1", 1-1/2", 2", 3", 4"

Options: M, V, N, P2, P3, P4, P5, P6, P7, P8

For magnetic option add .312

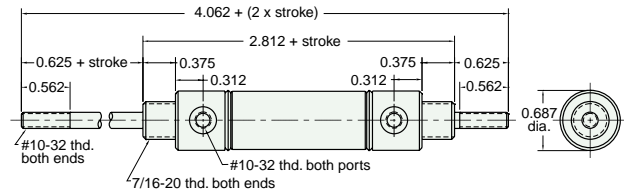

Furnished without nut(s). Order Part No. N07-20-SS.

CR-SDR-10-□-□

Double Acting

Mount: Stud
Type: Rotating Rod

Standard Stroke Lengths: 1/2", 1", 1-1/2", 2", 3", 4"

Options: M, V, N

For magnetic option add .312

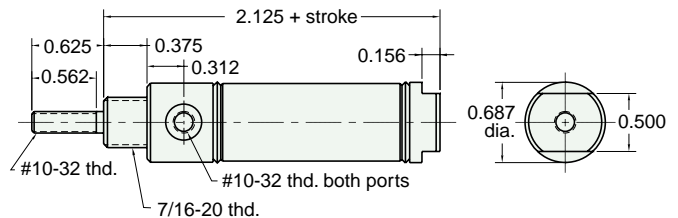

Furnished without nut(s). Order Part No. N07-20-SS.

CR-UDR-10-□-□

Double Acting

Mount: Universal
Type: Rotating Rod

Standard Stroke Lengths: 1/2", 1", 1-1/2", 2", 3", 4"

Options: M, V, N, P2, P3, P4, P5, P6, P7, P8

For magnetic option add .312

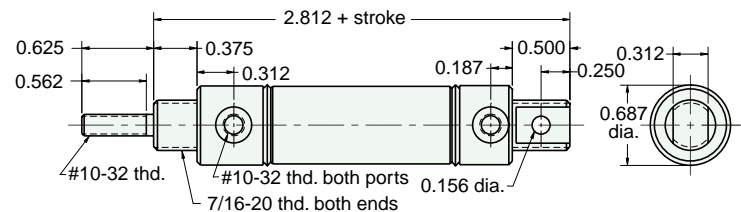

Furnished without nut(s). Order Part No. N07-20-SS.

Stainless Steel Mounting

Foot Bracket

Model Number: FB-0892-SS

Nut

Model Number: N07-20-SS

Max. Torque in lbs.: 4.0

